

Michael Sickler

~~Jonathan Walker~~

Post East 160 Post

John Gifford

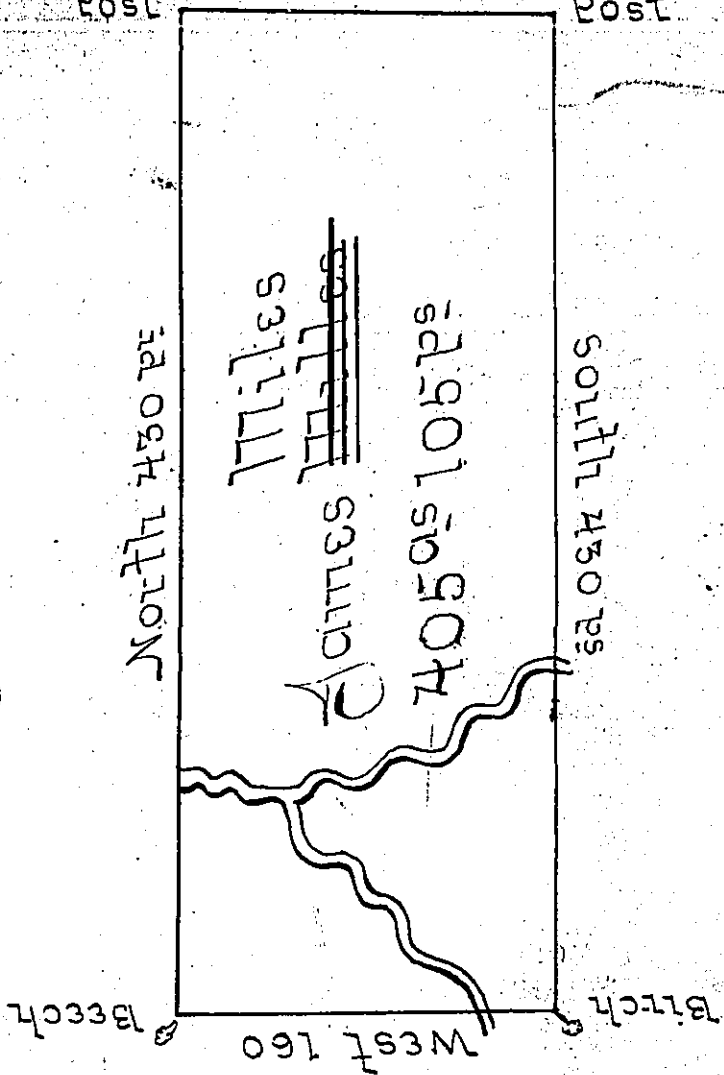

John Patton

Situated on the Waters of Blacklick Creek in Wheatfield Township Westmoreland County. Containing 405 Acres & 105 perches & Allowance for Roads &c surveyed for James ~~Walker~~ <sup>Miles</sup> the 17<sup>th</sup> day of Novem<sup>r</sup> 1794 on Warrant Dated 3<sup>d</sup> day of May 1793

James Ross U.S.

Daniel Broadhead Esq<sup>r</sup> S<sup>r</sup>

IN TESTIMONY that the above is a copy of the original remaining on file in the Department of Internal Affairs of Pennsylvania, made conformably to an Act of Assembly approved the 16th day of February, 1833, I have hereunto set my Hand and caused the Seal of said Department to be affixed at Harrisburg, this fourth day of February 1902.

*James W. Latta*  
Secretary of Internal Affairs